



Achievers



ACCURATE SOLUTIONS FOR FLOW MEASUREMENT

- INDUSTRY LEADER
- OVER 5 YEARS OF EXPERIENCE
- EFFICIENT AND DURABLE PRODUCTS
- WIDE RANGE OF SELECTION
- LOW MAINTENANCE



CE - 210

HELICAL FLOW SENSOR & DISPLAY

CE-210 ACHIEVERS Developed Helical Flow Meter is a superior choice for flow measurement of very high viscosity fluids with the help of Positive Displacement Technology. With the latest technology of K-factor this flow sensor is a very good choice for fluids with changing flow rates. Achievers Flow Sensor provides great accuracy and repeatability over the full range of measurement. This flow sensor is considered the best choice for measurement in laminating systems, painting systems, adhesive dispense systems, as well as batching systems for various fluids.

Features

- High accuracy
- Max Pressure: up to 25 bar
- Independent of viscosity, ideal choice for fluids with 1 to 106 mm²/s viscosity.
- Low pressure drop compared to other positive displacement meters
- High resolution of display
- Pulsation-free measurement, non-sensitive to pulsating flows
- Resistant to corrosion by advanced materials and bearings

Technical Details

- Material of construction:
- Enclosure : PA66 + GF
- Rotor : PA66/POM/PPS
- Shaft : Hard Stainless Steel-316
- bearing : carbon/pom with hard S.S. BALL
- Accuracy (standard installation position) : +/- 0.5 or 1% FSD
- Repeatability : 0.05%
- Maximum working pressure : 2.5 Mpa
- Fluid & Ambient temperature: -40 to 120 Deg. C
- Connection: Thread (M)



Applications:

- Petrochemical Products
- Light and Heavy Fuel Oil
- Fat and oils with changing viscosities
- Glycol / Water mixtures
- Thixotropic Fluids
- Polyurethane and p\Polymer
- Test rigs with varying viscosities and fluids
- Crude oil, furnace oil, and all viscous liquid even viscosity change with Temperature
- Ideal choice for water atm, water dipensing, tea/coffee/wine/juce and other food liquid measurement and other dispensing system.

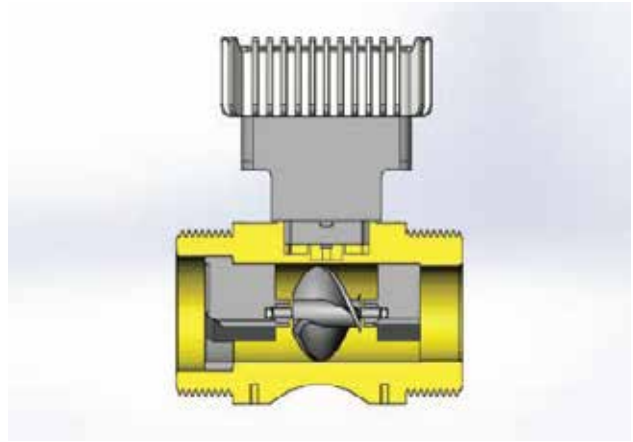

Selection Choice:

1) Pulse output sensor :

a) Hall / Reed sensor or Pickup Coil

Power voltage: 5 to 24 V DC/ Low power: 2 to 5 V DC

Output: high electric level : High than 4.5 V DC

(input voltage 5 VDC)

low electric level : lower than 0.5 V DC

(input voltage 5 VDC)

2) Battery operated meter :

Power voltage: 3.0 V batteries can be used more than 1 years in a row.

Display mode:

Two row Liquid Crystal Display (LCD)

Cumumlative flow: automatically expand the display precision, the cumulative flow/partial values can be reset.

Power-fail protection: instrument coefficient, the Total flow values is not lost when power supply drop.

3) Display with 4 to 20 mA Output

Power voltage: 24 V DC

Output signal: 4 TO 20 mA

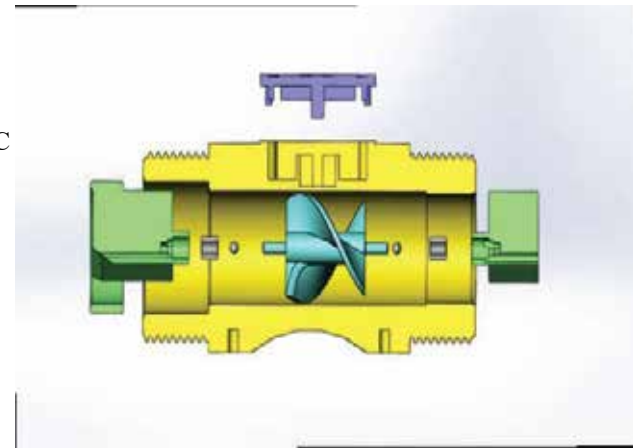

Available Sizes :

Model	Line Size	Flow Range(Litre/Hour)	Pulse/Litre
CE-210-004	¼" BSP	5-40-400 L/H	4200
CE-210-008	½" BSP	10-150-1500 L/H	1200
CE-210-012	¾" BSP	50-500-5000 L/H	215
CE-210-020	1" BSP	80-800-8000 L/H	97
CE-210-25	1.25" BSP	100-1000-10000 L/H	52

CONTACT US



A/29 - Bhagirath Estate,
Nr. Gulab Nagar, Amraiwadi
Ahmedabad, INDIA- 380026



+91-9824970261
+91-9574992851

Some of Our Clients

